



# Sustain the Potential of our Place.

SAVE   
Kāpiti Airport

Save Kāpiti Airport  
champions protecting  
our national strategic  
asset for the benefit of  
future generations.

A co-created kaupapa  
committed to  
honouring Te Tiriti  
principles of  
protection,  
partnership, and  
equity.

## Guiding Principles

Partnership with key stakeholders

Open transparent engagement

Vision for long term value creation

*Incorporated Society (KAPSI) established.*

SUPPORT   
**Kāpiti Airport**

- Choose our local air carrier
- Help us rally & connect local voices to collectively lobby the Council
- Financially support this cause & the potential of our place - find out how

SUSTAIN   
**Kāpiti Airport**

- Continuity of disaster recovery and civil defence services
- Access to lifesaving emergency services in Wellington
- Tourism & ability to attract large scale events
- Regional distribution of goods & services
- Restoration of environmental assets
- Retention of open spaces and walkways

WAHAKAHAUMARU   
**Kāpiti Airport**

- A key link in regional air transport infrastructure
- Economic growth: high value jobs & connectivity
- Contemporary housing that is eco-efficient urban
- Recovery of cultural value and mana whenua

# What does success look like? What do we care about? An holistic and balanced view is up to us all to develop ...

**PAST**  
Greenhouse gas emissions 2018

45.5 MT CO<sub>2</sub>

**PAST**  
Tourism expenditure was approx

\$157 M 2019-20

**PAST**  
Jobs in Health & Social Assistance

Makes up about 15% GDP in Kāpiti

**PAST**  
In 2018 report shows retaining the airport is worth

\$4.3 M Annually in our region

**PRESENT**

90%+

Employed in services...private and public sector.

**PRESENT**

78.1%

Agree the airport is an important economic asset.

**PRESENT**

70% ... and declining

New Zealand productivity against OECD average...

**PRESENT**

GDP for the Kāpiti District was almost \$2B

**FUTURE**

Higher paid, more export.

**FUTURE**  
Council upgrading infrastructure

\$280 M Over the next 30 years

**FUTURE**  
Population growth forecast

85,658 By 2051

**FUTURE**  
Carbon Neutral Aotearoa.

Net 0 By 2051

# Multiple use options deserve to be explored ...

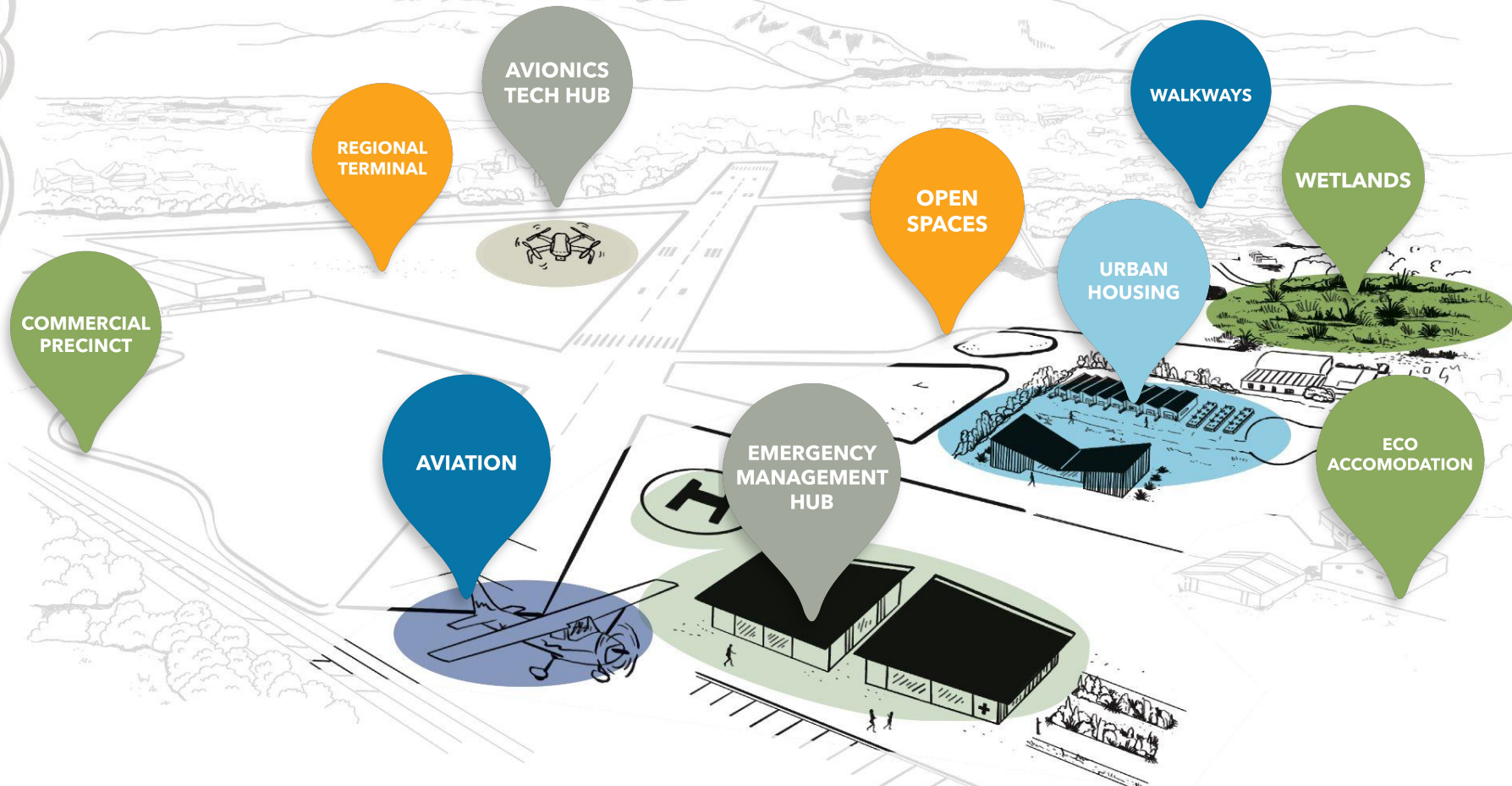

- Demand for space and satellite services is growing rapidly - driven by digital transformation and IoT
- Adoption of autonomous and urban aviation is taking-off
- Transportation is undergoing a dynamic shift from fossil fuels to renewables

GLOBAL SPACE INDUSTRY HAS A

**720**<sup>B</sup> GROWING VALUE

Global Urban Air Mobility market size is expected to reach.

**7.9**<sup>B</sup> BY 2030

Global Sustainable Aviation Fuels (SAFs)

ARE EXPECTED TO DELIVER

**40%**

of aviation fuels by **2050**

AVIATION

AVIATION FUTURES

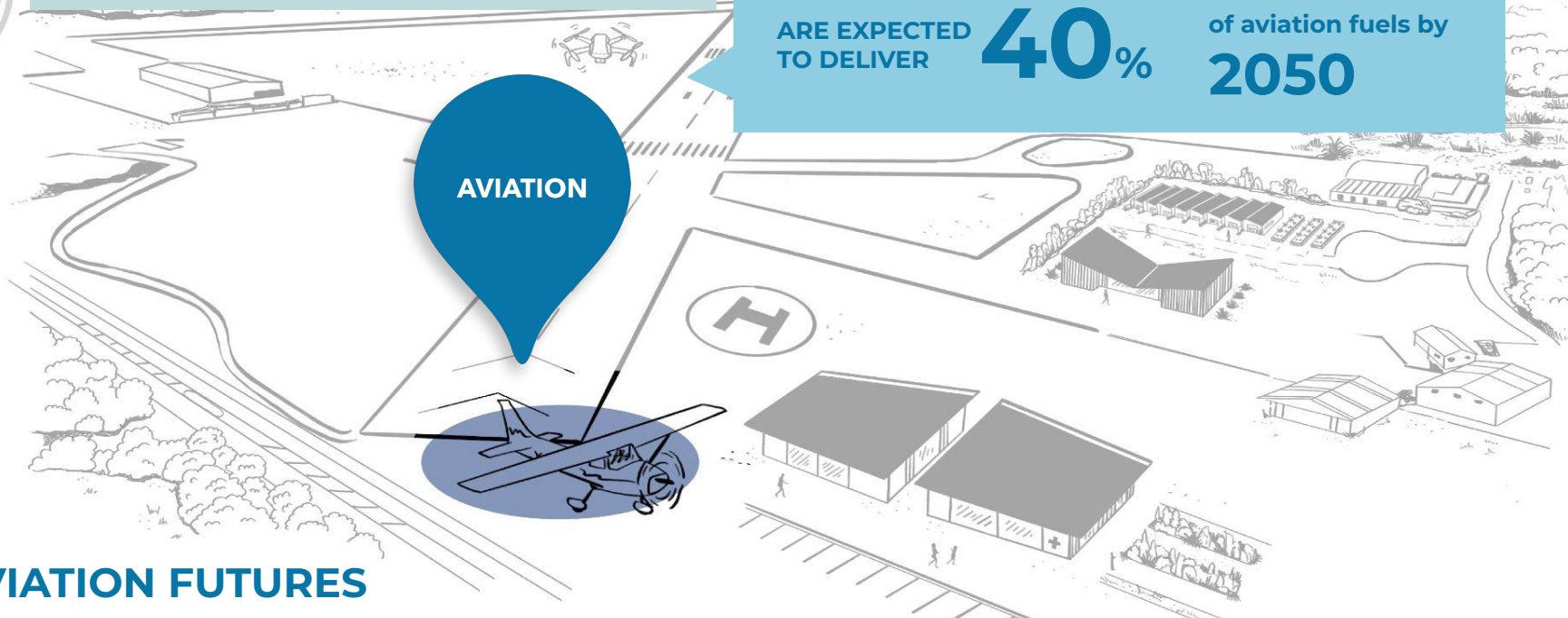



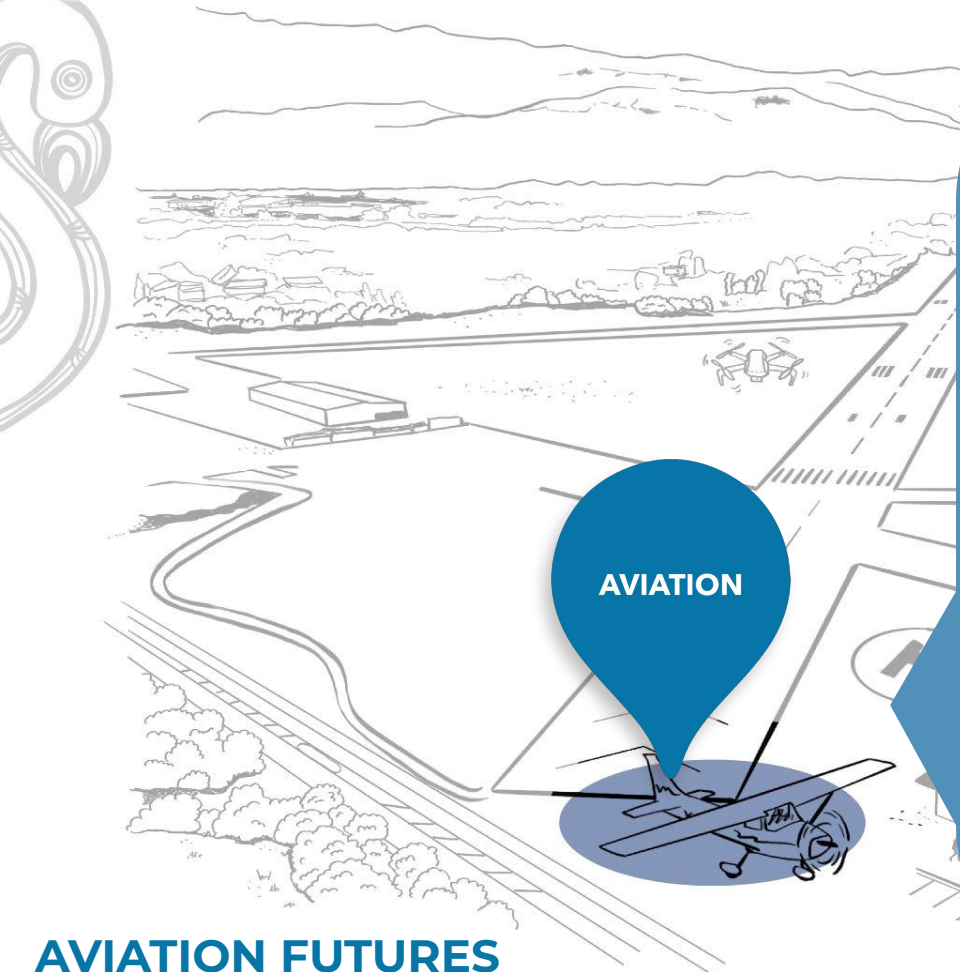

“Kāpiti airfield presents an opportunity for our district to become a National leader in carbon emission reduction through the utilisation of E-commuter aircraft.

The development of this technology and establishing an E-commuter hub will present significant business and education opportunities for our community.

The Kāpiti Council and Economic Business Development Agency should be working on plans to develop Paraparaumu airfield as a electric aviation ecosystem, thereby capitalising on the environmental, economic and education opportunities present by this important community asset.”

**Shaun Johnson, Merlin Labs.**

## AVIATION FUTURES

Let's lead the world  
in a point-to-point  
air transport system  
connecting whānau  
across Aotearoa.

Point-to-point  
transport is the future.  
Imagine calling an  
AirCab on demand.

Fast, efficient,  
sustainable. *On time  
Delivery!*

Kāpiti as a key hub  
with air, rail, road in  
close proximity.





The future is now ... this is all happening in NZ.



**Dawn Aerospace is redefining near-space transportation for a circular and sustainable space economy.**



**Wisk are pioneering an entirely new way to fly, our all-electric, self-flying air taxi rises like a helicopter and flies like a plane.**



**Sounds Air is re-imagining NZ regional aviation.**



**The Merlin Labs team is building the definitive AI / autonomy system for all things that fly.**

# AVIONIC INNOVATION

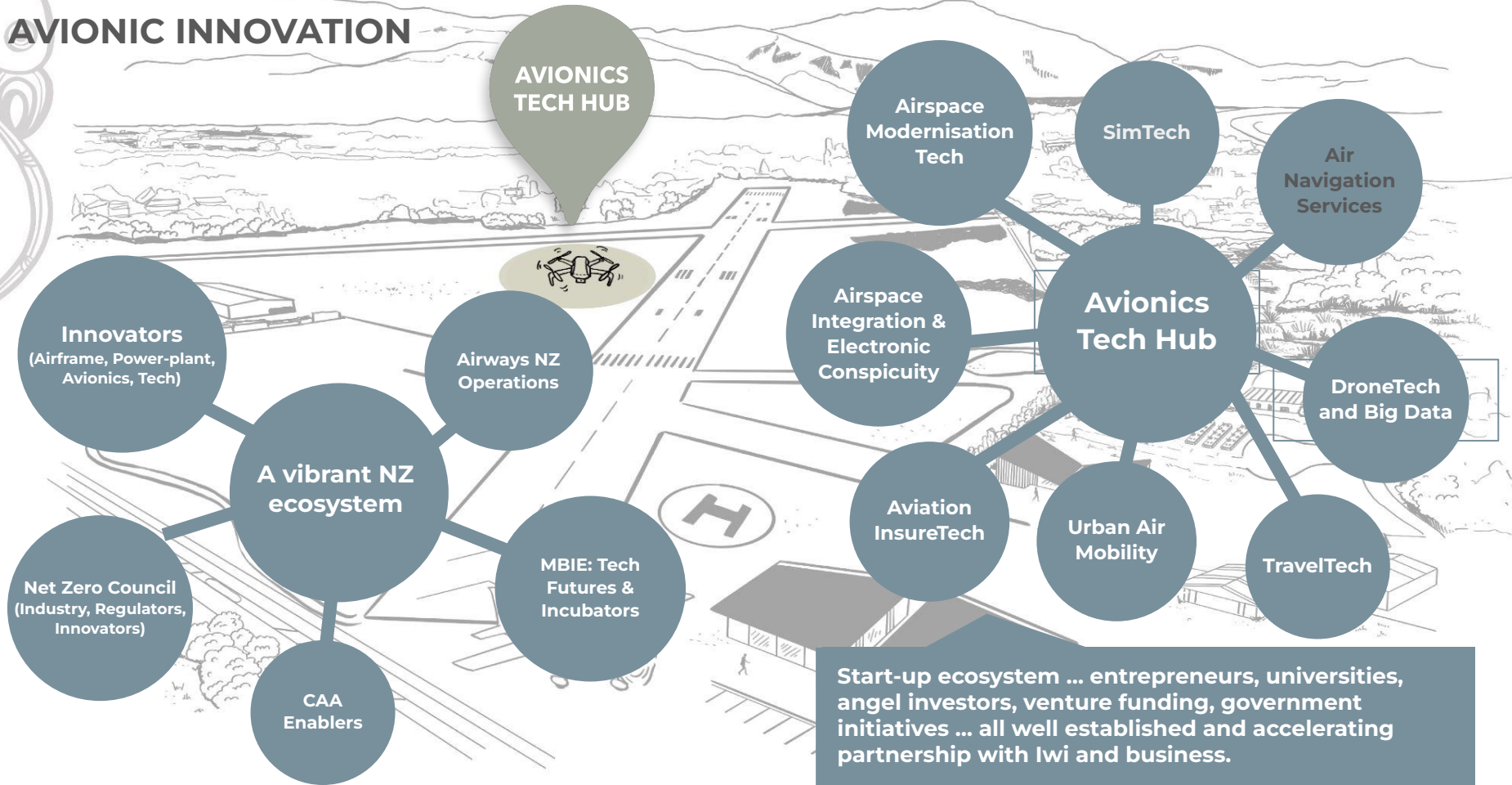

# AVIONIC INNOVATION

AVIONICS  
TECH HUB

Majority of net  
new roles created  
by innovative  
startups

Retaining our  
best people  
within the  
region

Productivity Commission  
challenges us collectively and  
individually to raise the value of  
work which flows through to  
wellness for communities. Let's  
create exciting career prospects  
for our rangatahi in Kāpiti.

Export

Technology jobs -  
90% jobs in Kāpiti  
are services jobs

Employment

Intellectual  
property

Roles related to  
impact—  
environment,  
energy, aviation,  
tourism

Incubators &  
accelerators  
(MBIE /  
Callaghan)

Higher  
paid roles

Productivity  
gains for  
Aotearoa



AVIONICS  
TECH HUB

“We wouldn’t want to imagine Kāpiti with no airport. A vibrant, coastal city that punches above its weight. Leap forward, the world has moved to what today, we call ‘future of flight’; silent, sustainable, electrified urban air mobility that creates jobs and connects New Zealanders to each other and the world. Why would we give up on this chance”?

**Katherine Corich, Entrepreneur, Global Aviation Innovation & Sustainability Leader.**

AVIONIC INNOVATION





REGIONAL  
TERMINAL

## AIRPORT INFRASTRUCTURE

- **Compact footprint** all aviation activity concentrated around existing sealed runway
- **Runway side safety clearances** achieved and airport meets all Civil Aviation Authority requirements for safe and efficient operation of SAAB 340 sized aircraft
- **Noise berm** for new western residential area
- Existing airport wetlands retained to provide natural drainage, open space and habitat

Scheduled services  
using aircraft of up to:

**30 SEATS**  
(SAAB 340)

**RUNWAY  
LIFE  
EXTENDED** **5  
YEARS**

Airport remains  
fully operational  
and useful.

Less than half current land area needed  
for aviation use (~45% of the 130  
hectares).



REGIONAL  
TERMINAL

## SERVICES AND VIABILITY

- Dynamic and positive management committed to a viable airport for long term
- Greater confidence and better terminal will encourage scheduled operators to invest in Kāpiti services.
- Expanded provision for hangars and aviation business to encourage General Aviation use
- Use already tracking towards where airport aviation income can balance annual operating costs, with careful control of expenses
- Compact Airport Development Zone (Retail and business) to meet remaining longer run costs

2021 movements already exceed pre-Covid levels.

BY **28%**

**Additional income from leases covers longer term infrastructure renewals.**

Kapiti Annual Movements  
2012-2020 Actual  
2021 Extrapolated from Q1 actual

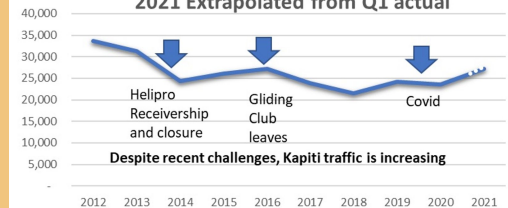

Compact development zone covers long run costs.

Airport remains fully operational and useful.

Existing airport wetlands retained.

Noise barrier for new residential area.

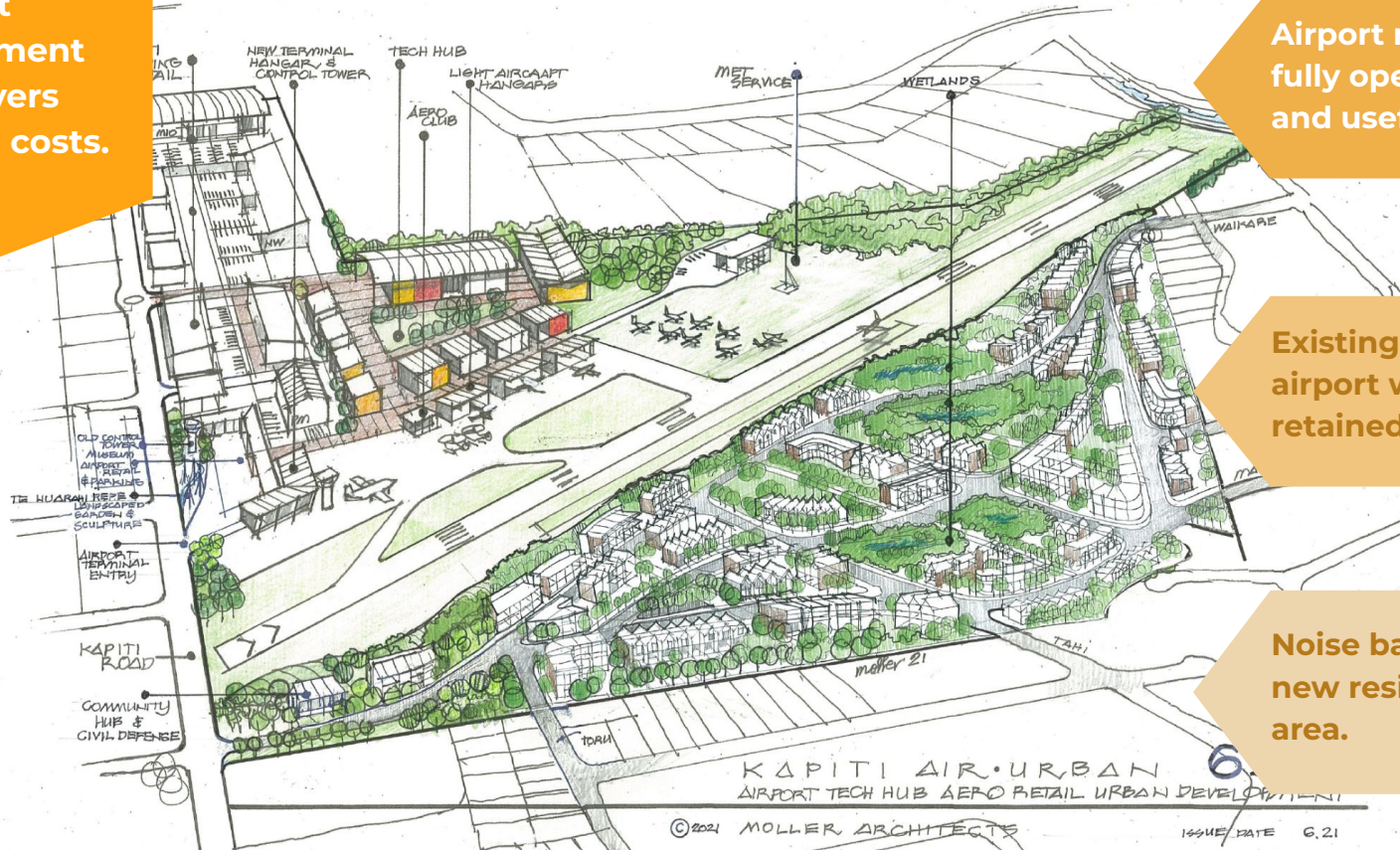



New look airport ideally set up for tomorrow's zero emission aircraft connecting Kāpiti directly to other centres—strategic asset for future of Kāpiti.

Confidence in future and better terminal encourages scheduled operators to invest in Kāpiti services.

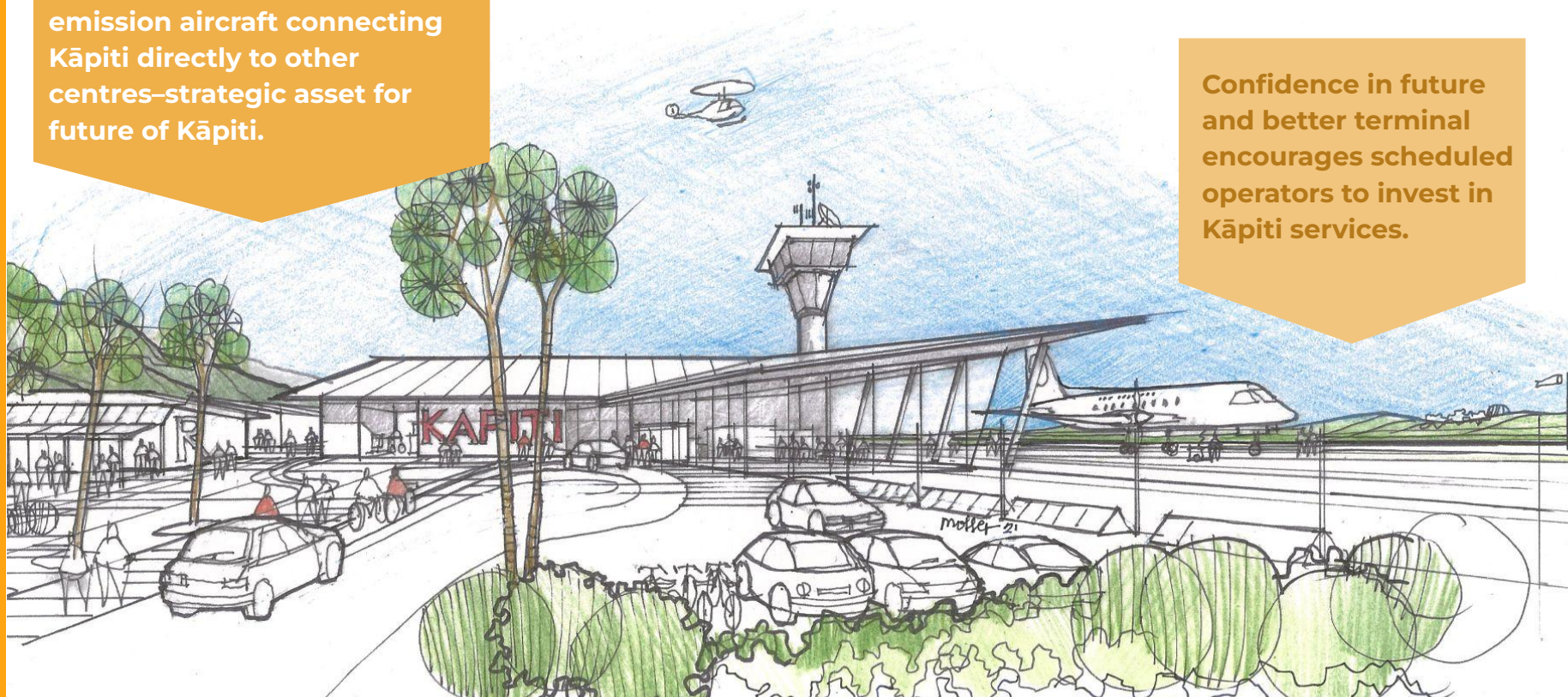

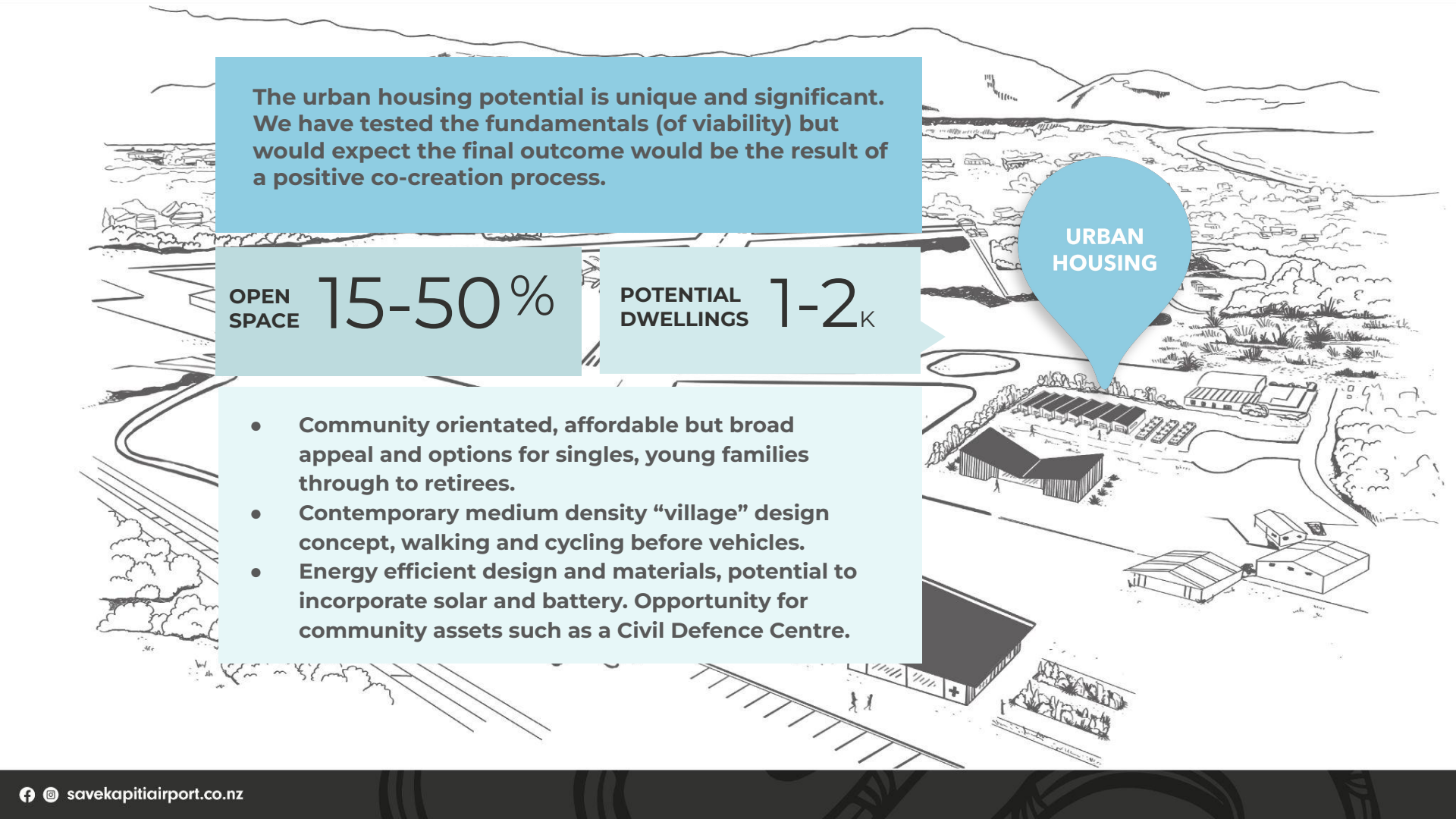

The urban housing potential is unique and significant. We have tested the fundamentals (of viability) but would expect the final outcome would be the result of a positive co-creation process.

OPEN SPACE

15-50%

POTENTIAL DWELLINGS

1-2<sub>K</sub>

URBAN HOUSING

- Community orientated, affordable but broad appeal and options for singles, young families through to retirees.
- Contemporary medium density “village” design concept, walking and cycling before vehicles.
- Energy efficient design and materials, potential to incorporate solar and battery. Opportunity for community assets such as a Civil Defence Centre.





**Modelled on a proven medium density housing model that improves the wellbeing and longevity of growing populations.**

“Designed to respect and respond to the coastal environment for sustainable living, designed for passive solar gain and sun and wind control, photo voltaic generation, reverse charging capability of EVs, strong urban design, generous landscaping and open spaces, shared vegetable gardens...”

**Gordon Moller, ONZM, Architect**

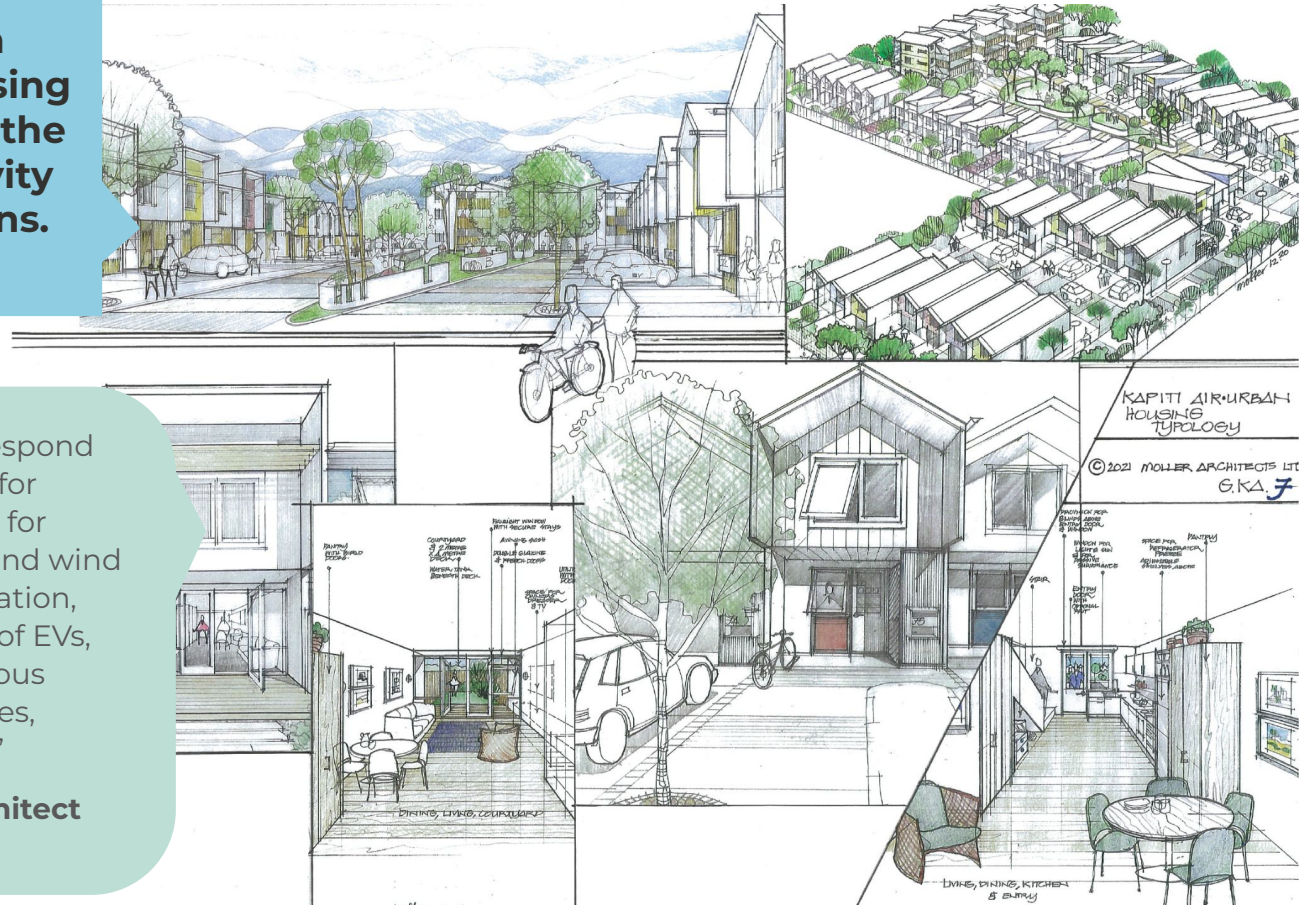



WETLANDS

CULTURAL LANDMARKS

Environmental outcomes are fundamental to the Kapiti Airport vision. Connecting walkways and cycleways, enhancing cultural and creative assets, restoring wetlands and open spaces for ecology and community.



**Kāpiti has a unique opportunity (responsibility) to create a leading social enterprise to put us on the global map!**

---

KOTAHITANGA  
MANAAKITANGA  
WHĀNAU  
KAITIAKITANGA  
WHAKAPAPA

**Voluntary, “best efforts” process needs formal accountable leadership**

**Multiple surveys and LTP submission provide material mandate to Council**

**A catalyst to accelerate Economic Development Strategy for the EDKB**

**Supports Government vision for ESG based Sector Transformation Plans**

**Significant private and public sector capability and capital deployed for Impact**

**We will never get another chance...**

---

ECONOMIC

---

